

3

INITIAL SNF III ASSEMBLY REQUIREMENTS

REQUIRED ASSEMBLY STEPS

- 1.....Assemble Tongue (# 3) to Frame (# 1) as shown using (2) 3/8-16 x 2 1/2" long carriage bolts with (2) 3/8 serrated lock nuts--fully tighten (fig. 1)
- 2.....Assemble Hitch (# 4) to Tongue (# 3) as shown using (4) 3/8-16 x 1" long hex bolts with (4) 3/8 serrated lock nuts--do not tighten at this point (fig. 1)
- 3.....Connect Actuator Control Box (# 35) to Actuator Harness (# 36) as shown in (fig. 1a)

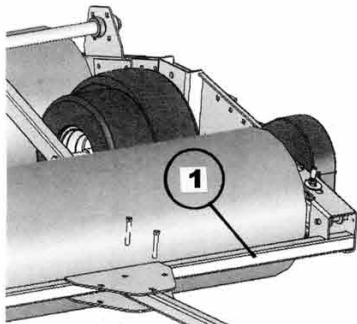

FIGURE 1.

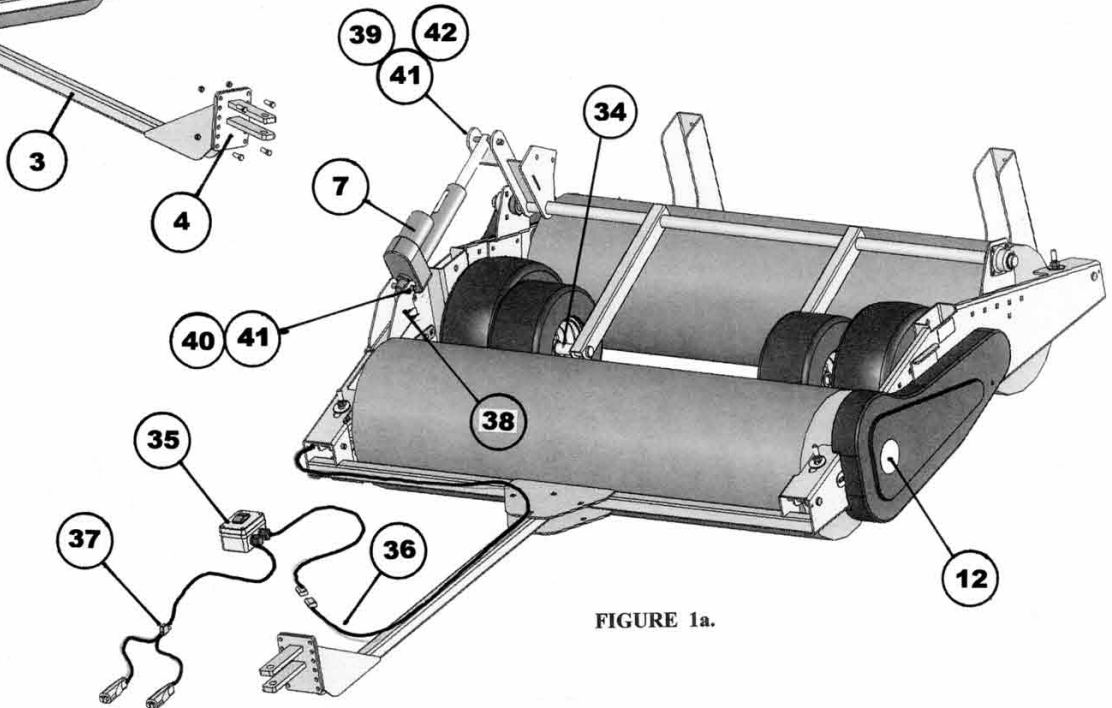
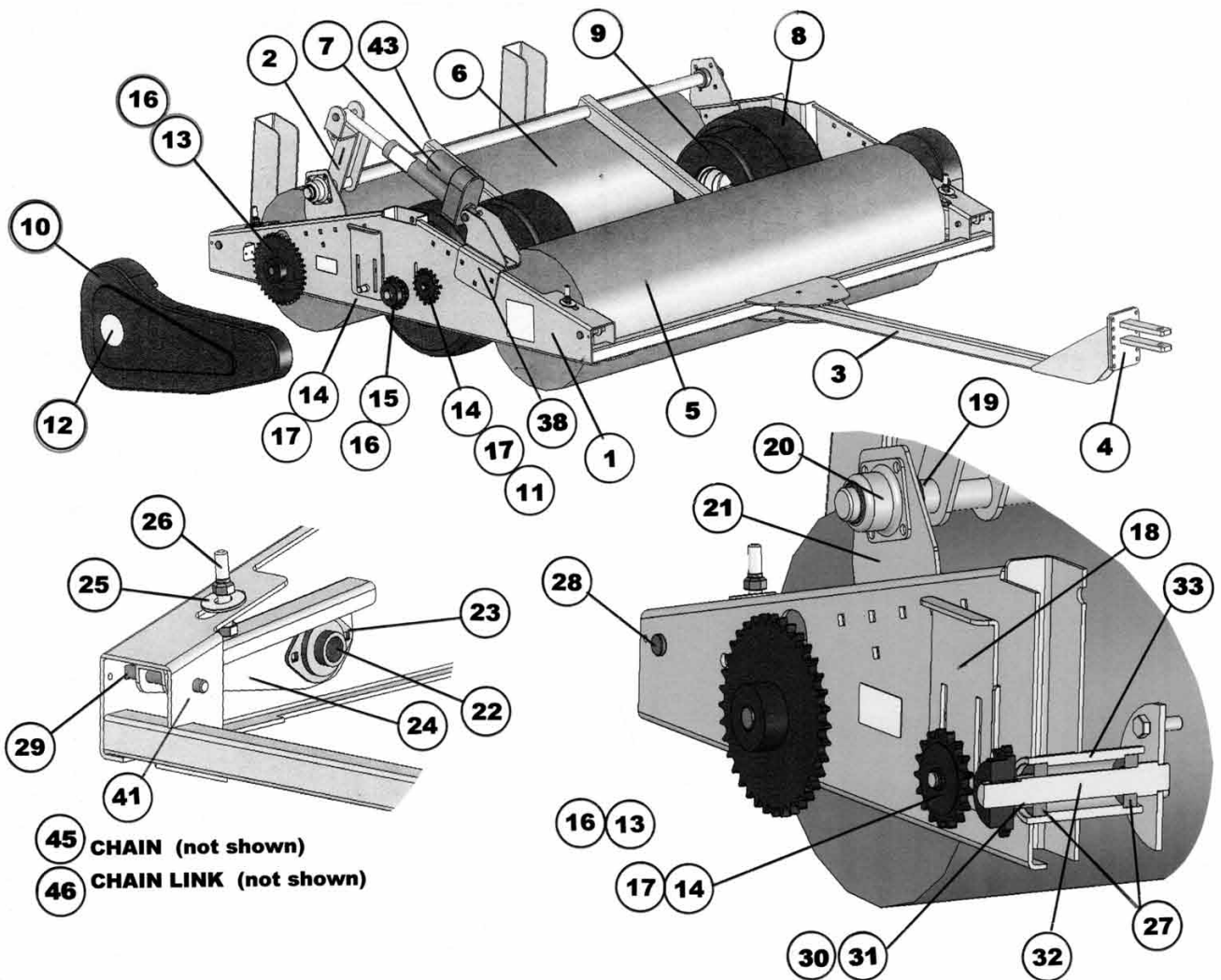

FIGURE 1a.



45 CHAIN (not shown)

46 CHAIN LINK (not shown)

8

BILL OF MATERIALS

#	NAME	REQ'D	NUMBER	DESCRIPTION
1	Frame assembly	1	12710-909	
2	Transport axle assembly	1	12710-908	
3	Tongue assembly	1	12710-903	
4	Hitch	1	12710-904	
5	Front brush assembly	1	12710-510	
6	Rear brush assembly	1	12710-510	
7	Electric actuator	1	ELECTRACK 10, 6"	12 volt
8	Drive wheel / tire	2	DM658-2TR1	16 x 6.50 - 8
9	Transport wheel / tire	2	W-DC6-3C-NB	13 x 6.50-6
10	Chain guard cover assembly	2	12710-500	
11	Reversing bracket assembly	2	12710-906	
12	Product decal	2	12710-520	
13	Brush sprocket	2	133-655	36 tooth # 50 chain
14	Idle sprocket / bearing	4	133-782 0.638 bore	17 tooth # 50 chain
15	Drive sprocket	2	133-586	16 tooth 3 50 chain
16	Key	4	953161	1/4 x 1/4 x 1 1/4 sq.
17	Retaining ring	4	68013	5/8 shaft .588 x .039
18	Idle bracket assembly	2	12710-905	1 1/4 ID
19	Lock collar	2	136-020	1 1/4 bronze sleeve
20	Bearing set	2	FEE20G	
21	Idle bracket	2	12710-045	
22	Bearing set	4	155-616 UC205-16	1" with locking collar
23	Bearing flange	8	52M-2-ZP	standard 2 bolt
24	Brush arm	4	12710-910	
25	Washer	4	33016	5/8 flat washer
26	Adjustment bolt	4		1/2-13 full thread hex
27	Bearing	4	1641-2RS	1" ID sealed roller
28	Clevis pin	4	CP-242	1/2 dia. x 4 long
29	Spacer	4	2868T11	1/2 ID x 3/4 long
30	Sleeve bushing	2	SS-3240 0434917	1" ID bronze
31	Washer	6	33445	1" ID x 1.50 OD x .075
32	Drive spindle assembly	2	12710-907	
33	Hub (must be welded)	2	12710-530	replaceable part
34	Spindle(must be welded)(page 5)	2	12710-540	replaceable part
35	Actuator control box (page 5)	1	12710-550	
36	Actuator harness (page 5)	1	12710-551	
37	Fuse (page 5)	1	12710-552	25 amp mini auto
38	Actuator bracket	1	12710-040/041	
39	Clevis pin-shaft (page 5)	1	CP-240	1/2 dia. x 3 1/2 long
40	Clevis pin-body (page 5)	1	CP-236	1/2 dia. x 2 3/4 long
41	Retaining pin (page 5)	6	Bow-120	retain actuator arms
42	Sleeve bushing (page 5)	2	SS-1620 0434716	1/2 ID bronze
43	Plastic cap	2	1258-8	ABS
44	Lynch pin (not shown)	2	P/N Hange-2	retain trailer wheel
45	Chain (not shown)	2	12710-560	#50 chain 60.75" long
46	Chain Link (not shown)	2	12710-561	#50 standard link set

4

INITIAL SNF III SETUP REQUIREMENTS

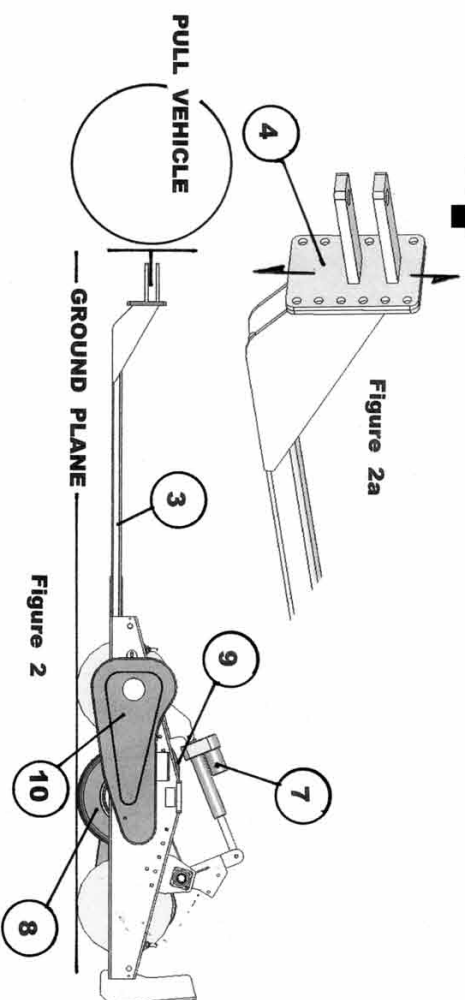

REQUIRED SETUP STEPS (Fig. 2)

- 1.....After initial assembly steps are completed position the SNF III on a level flat surface.
- 2.....Attach the SNF III to the desired pull vehicle. Adjust Hitch (# 4) up or down (Fig. 2a) such that Tongue (# 3) is parallel to the ground plane as shown in (fig. 2). Secure Hitch (# 4) in the desired position and tighten bolts.
- 3.....Connect the actuator control box battery clips to the pull vehicle battery.
- 4.....**WARNING.....Ensure that all actuator control box wiring is properly routed so entanglement is prevented.**
- 5.....Raise Transport Wheels (# 9) as shown in (fig. 2) such that the SNF III is resting on the Drive Wheels (# 8).
- Note: Actuator (# 7) is fully extended.
- 6.....Adjust (4) brush height adjustment bolts leaving 1/8" to 1/4" space between washer and lock nut (fig. 2b) (12.7mm to 25.4mm)
- 7.....Remove both Chain Guard Covers (# 10) and check chain tension. Chain should have between 1/2 to 1" deflection at point "A" as shown in (fig. 2c). If adjustment is needed loosen chain idler bracket assembly (# 18) and adjust up or down (fig. 2d) to get the desired chain deflection. Replace Chain Guard Covers (# 10).
- 8.....**WARNING.....Never operated SNF III with Chain Guard Covers removed !**
- 8.....Check the pressure---inflation both Drive and Transport tires to 14 psi (97 kPa)
- 9.....Always ensure that the SNF III is properly greased (see the maintenance section for lubrication points). For your convenience the SNF III has initially been fully greased in the Dream Turf factory.

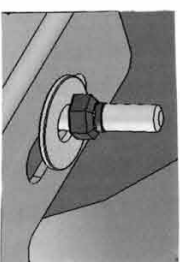

FIGURE 2b



FIGURE 2c

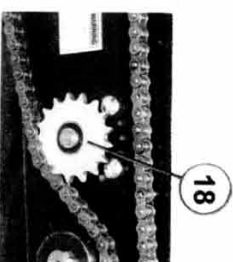

FIGURE 2d